

SOUTHWEST LOCAL SCHOOLS ES + MS STAFF UPDATE





AGENDA

...

- **Update: Where we are**
- **General project review**
- **Site plan review**
- **ES plan review**
- **MS plan review**

- **Split into ES + MS rooms – plan specific conversations + details**



WHERE ARE WE?

...

- **Completed Programming Phase**
- **Currently in Schematic Design phase** (*1 of 3 design and documentation phases*) – **SUBMIT MID-SEPTEMBER**
- **Break ground Spring/Summer 2019**
- **Occupancy Summer 2021**
- **Community updates woven throughout process**



COMMUNITY VALUES



- **Fewer students per teacher**
- **Safety and Security**
- **Student opportunities equal or better than others**
- **Technology: 1-to-1 connectivity; future flexible**
- **Educational options for all: career paths / college / starts at JS**
- **Flexible facility: spaces to support future education**
- **Air conditioning!**

SCOPE



3 NEW ELEMENTARY SCHOOLS
APPROX. 700-900 STUDENTS
GRADES K-5
2 @ 71,267 sq ft / 1 @ 75,183 sq ft

NEW JUNIOR SCHOOL
APPROX. 1,100 STUDENTS
GRADES 6-8
148,000 sq ft (*exist. = 84,295 SF*)

HS IMPROVEMENTS (NON-OFCC)
WV IMPROVEMENTS (NON-OFCC)

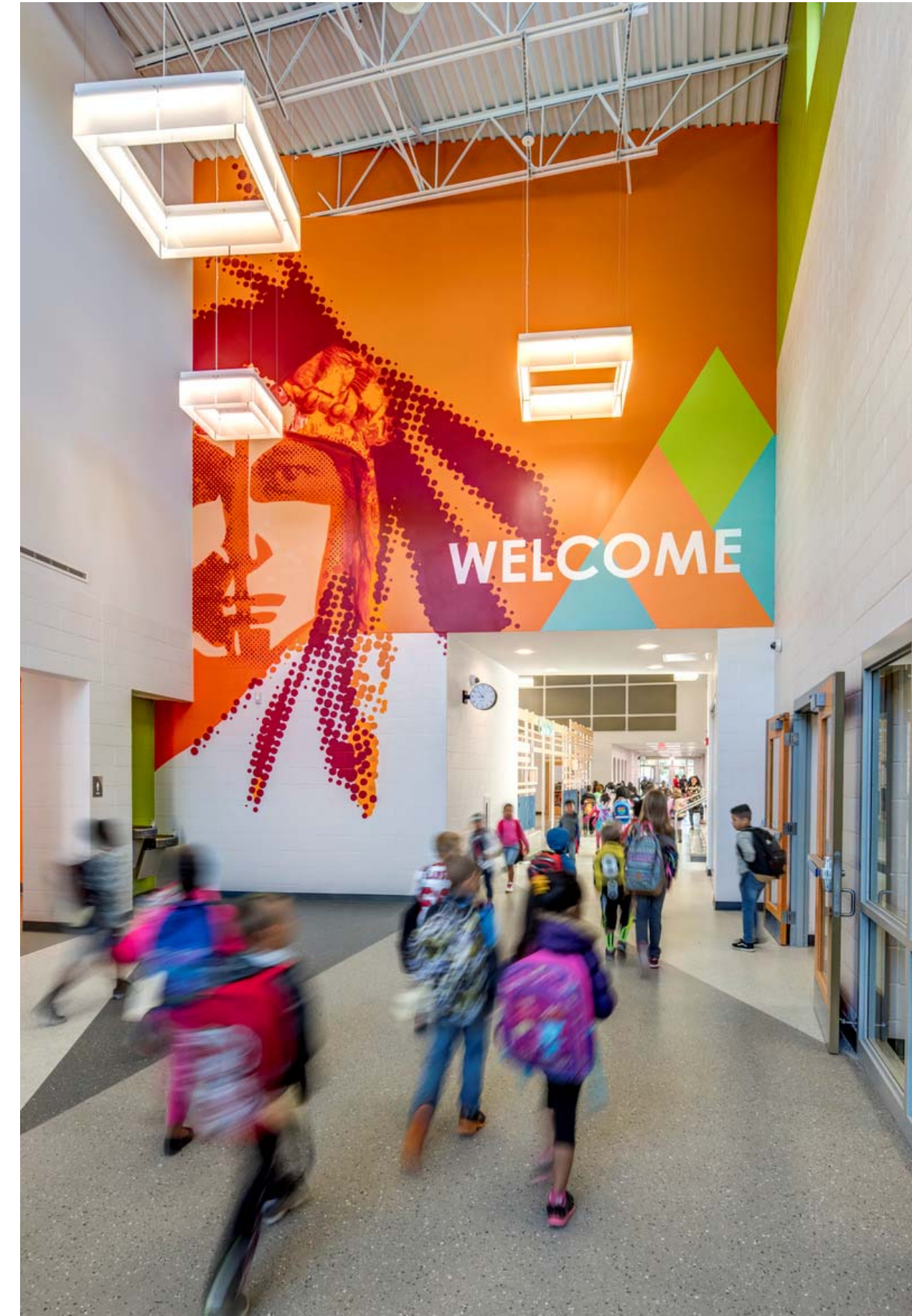



DISCLAIMER:

...

WE ARE STILL VERY EARLY
IN THE PROCESS.

THE PROJECTS WILL
CONTINUE TO EVOLVE AND
TAKE SHAPE OVER THE
NEXT SEVERAL MONTHS.

Whitewater Valley - Limited Improvements

...

- For Community Use and Preschool
- Limited Air Conditioning
- Security Improvements
- Fire Alarm Upgrade
- Site Improvements
- Budget \$800,000





Harrison High School Improvements



INCLUDED

- Security Improvements
- Science Lab Improvements
- Classroom and Restroom Upgrades
- Brick and Exterior Stair Repair
- New Windows and Roof in Original HS
- Lighting and Electrical Upgrades
- HVAC Improvements
- New Fire Alarm System
- Site Improvements
- Furnishings Upgrades
- All New Technology
- Budget \$10.15M

NOT INCLUDED

- All New HVAC (except Activity Ctr)
- All New Plumbing and Fixtures
- All New Electrical
- All New Finishes and Cabinets
- All New Roofing (except metal)
- All New Kitchen Equipment
- Sprinkler/Fire Suppression System
- All New Furnishings

SITE PLAN CROSBY ES

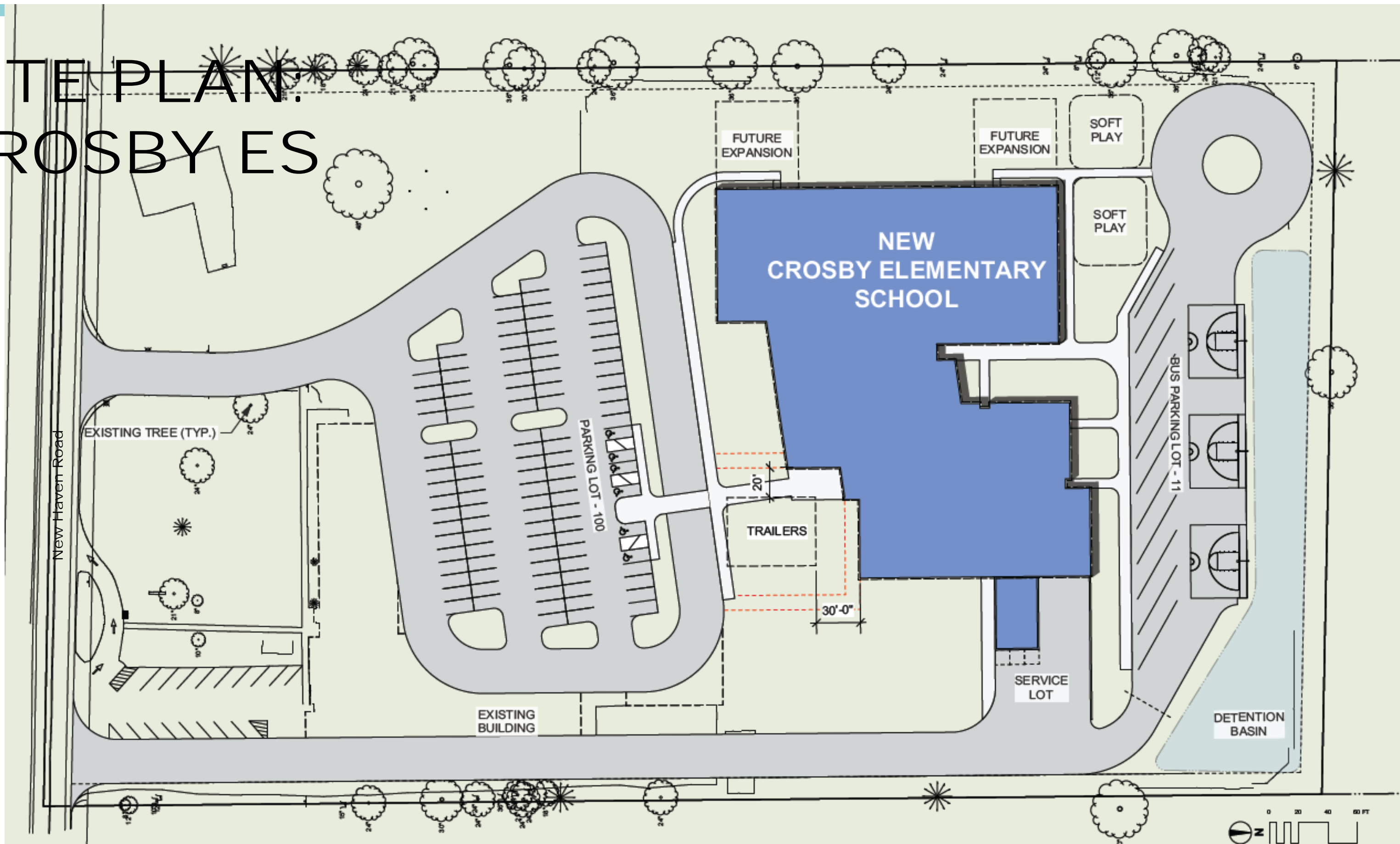

SITE PLAN: HARRISON ES

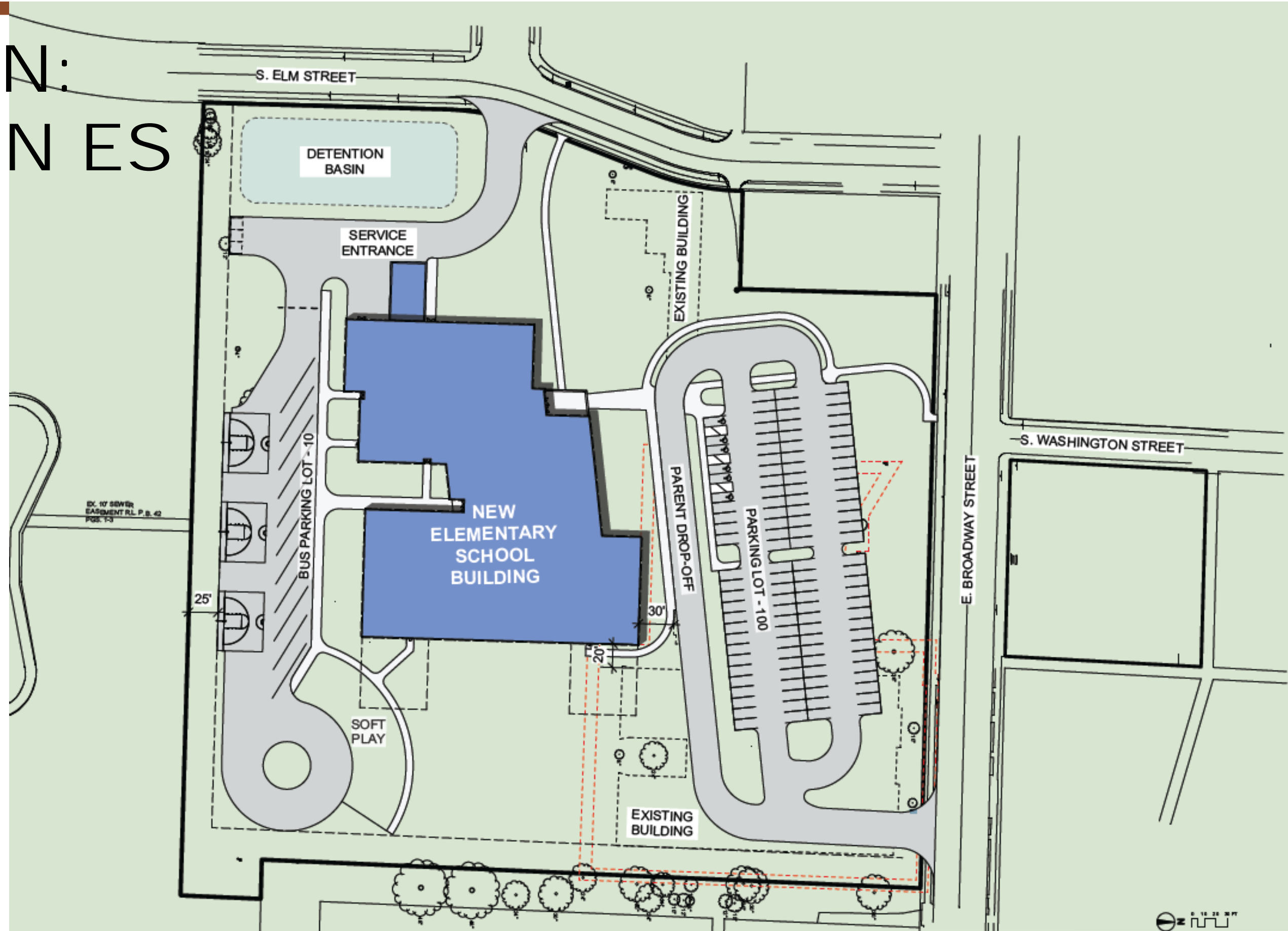

SITE PLAN: CENTRAL ES JUNIOR SCHOOL

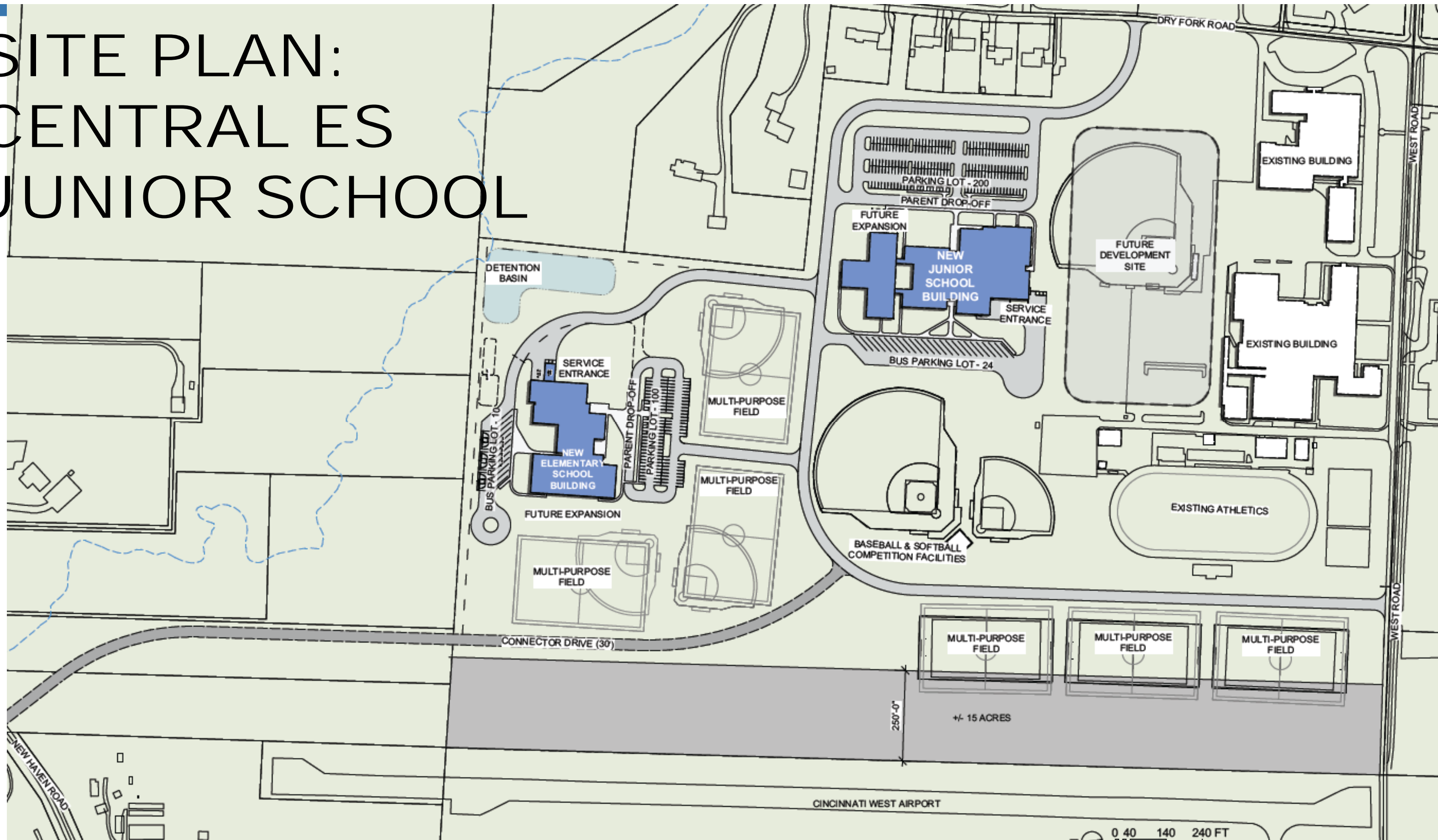

SITE PLAN: CENTRAL ES

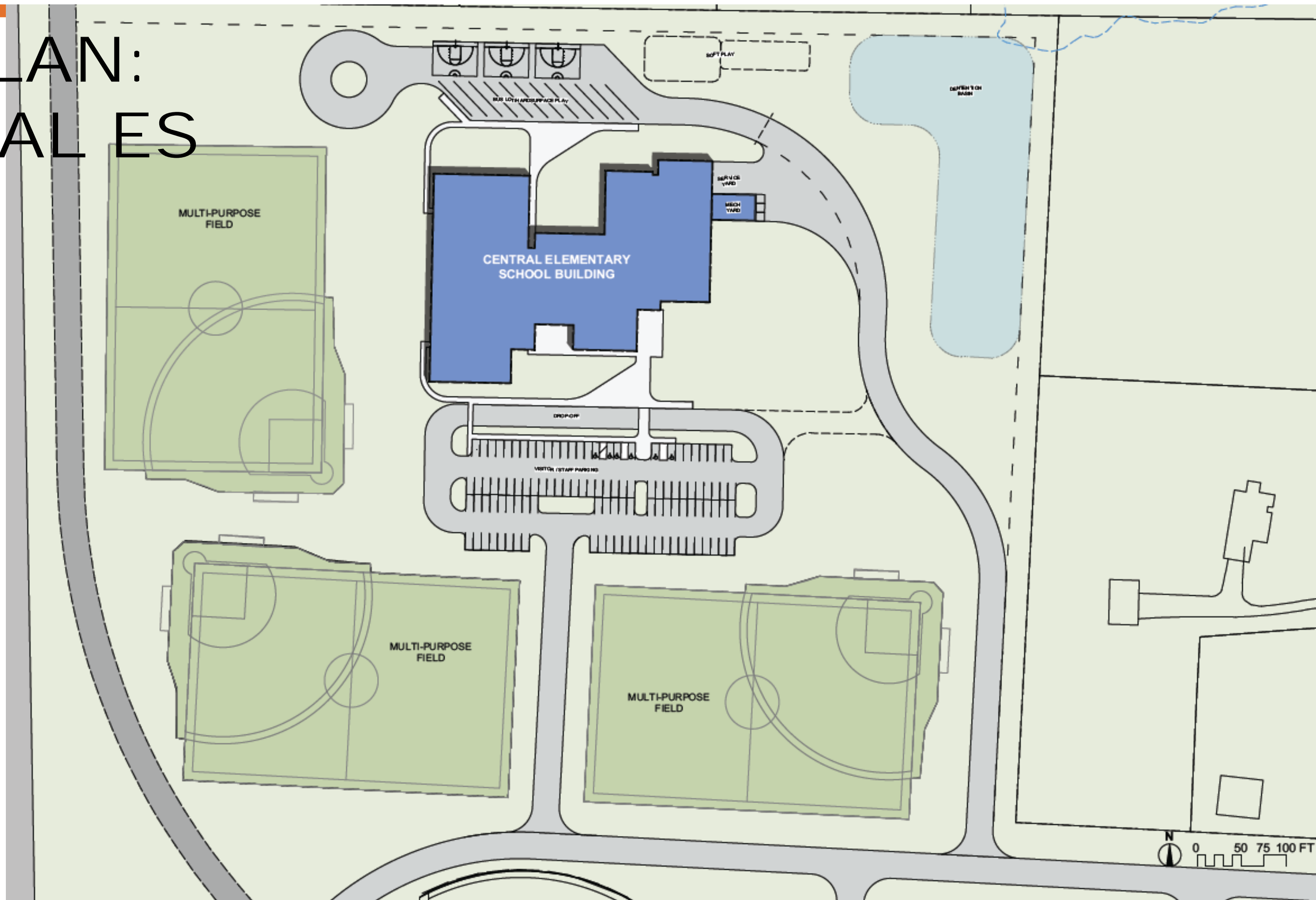

SITE PLAN: JUNIOR SCHOOL

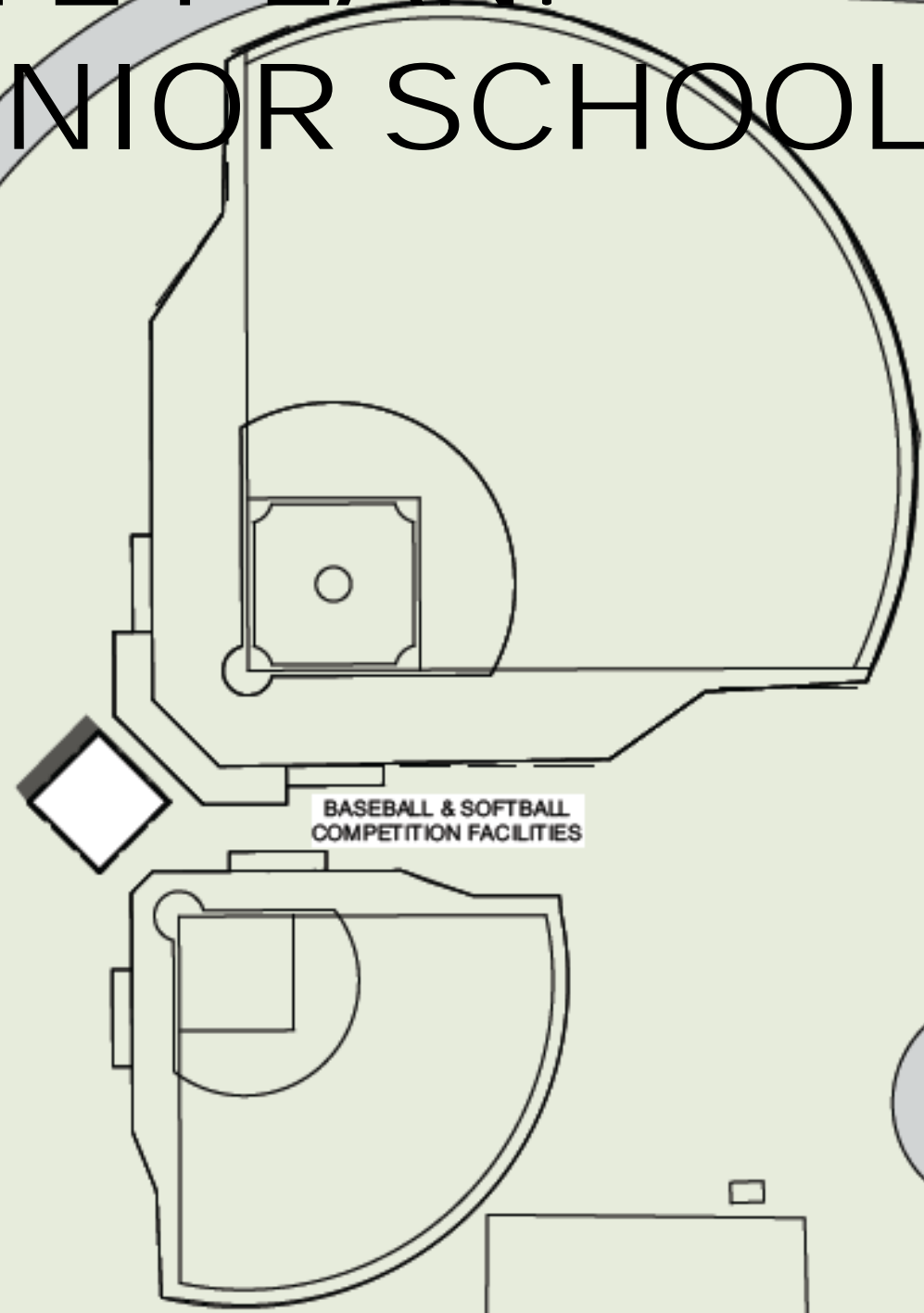

BUS PARKING LOT - 24

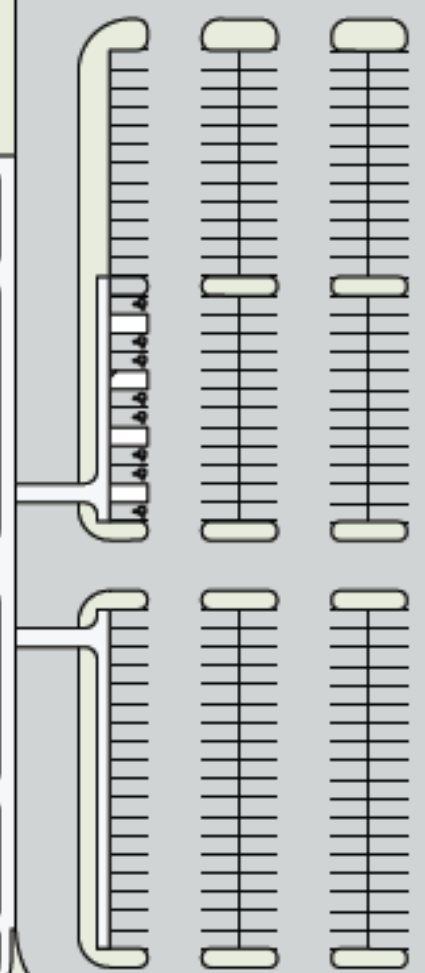
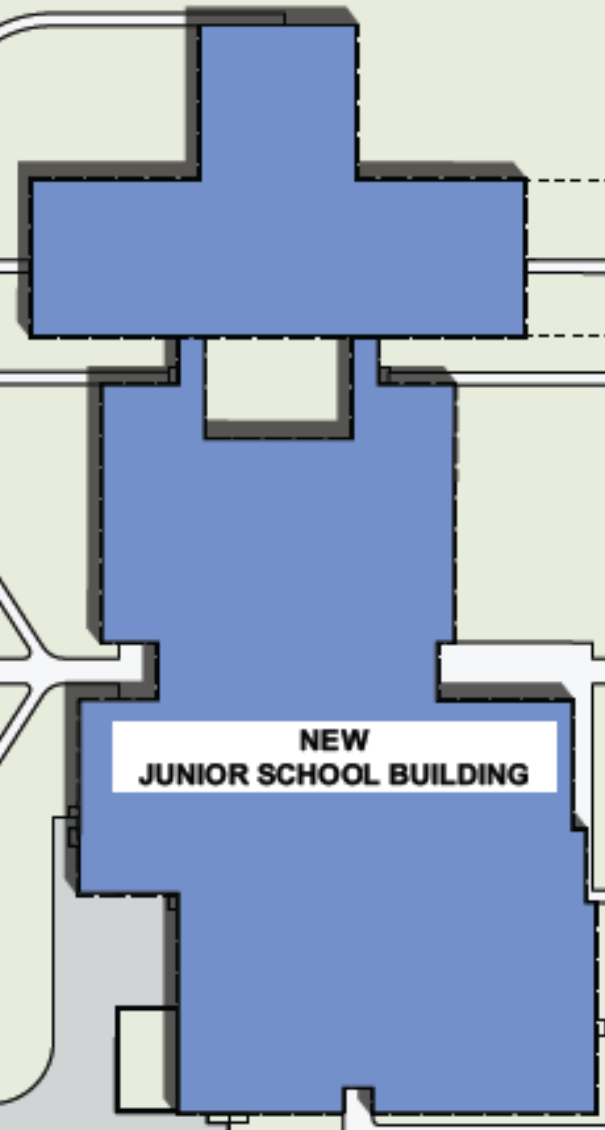

ELEMENTARY SCHOOL PLAN

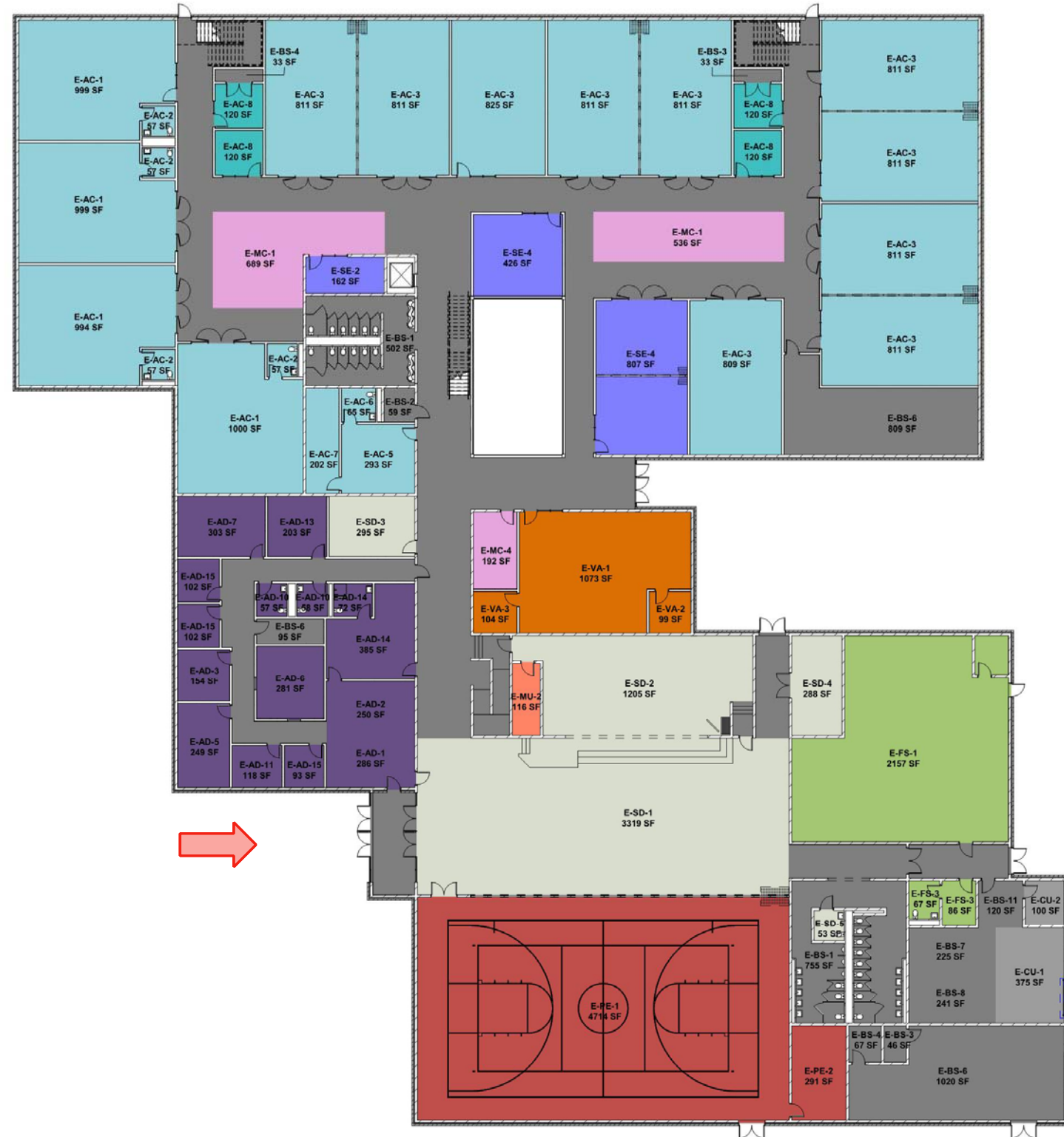

First floor

MIDDLE SCHOOL PLAN

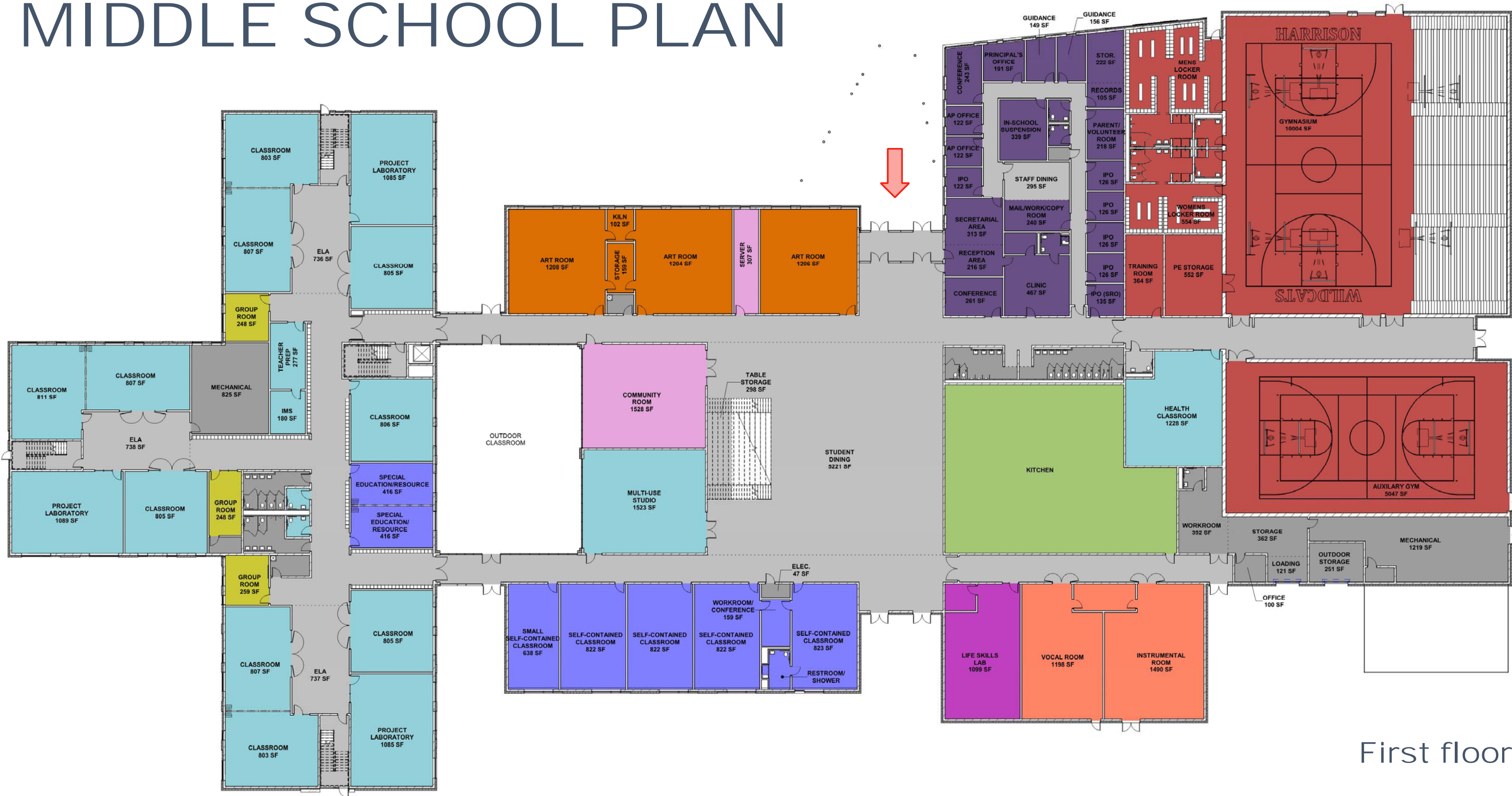

First floor

MIDDLE SCHOOL PLAN

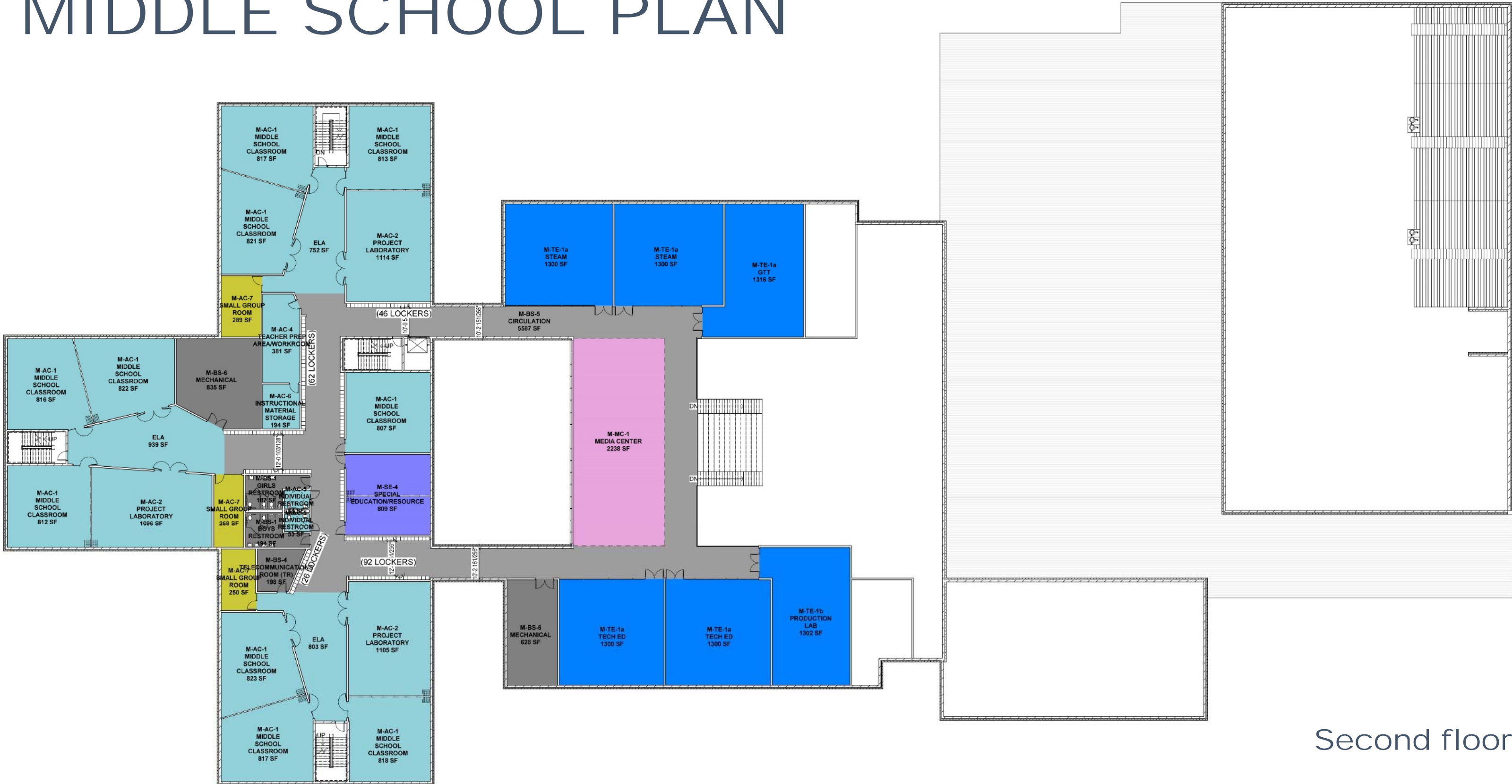

Second floor

MIDDLE SCHOOL PLAN



Third floor

4 SEPTEMBER 2018

THANK YOU!

